

CORNER BAY & BALCONY DETAIL

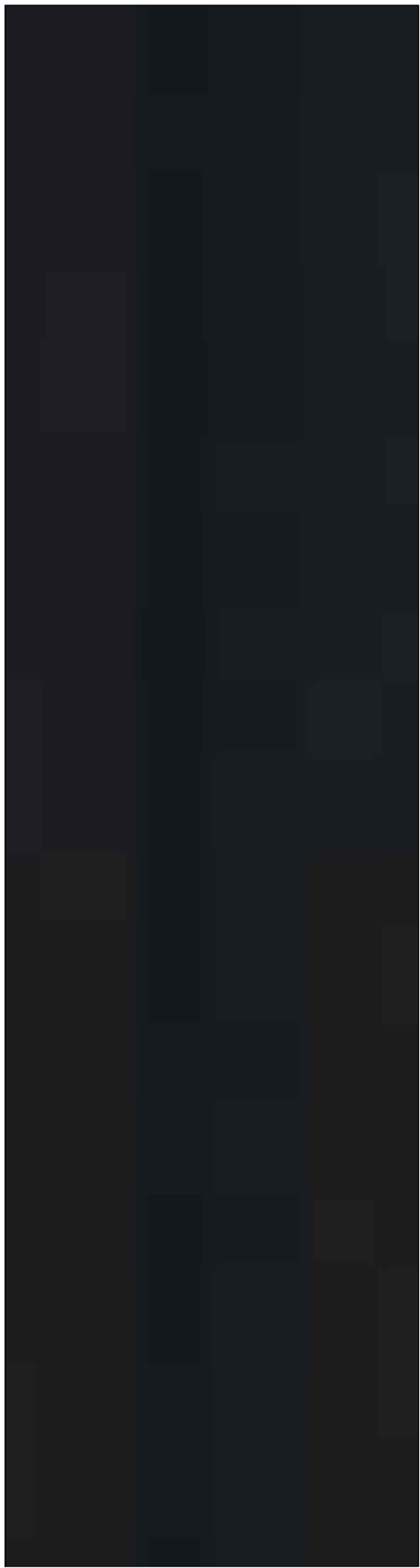

MP-1



1ST FLOOR CORNER & PEDESTRIAN PAVERS

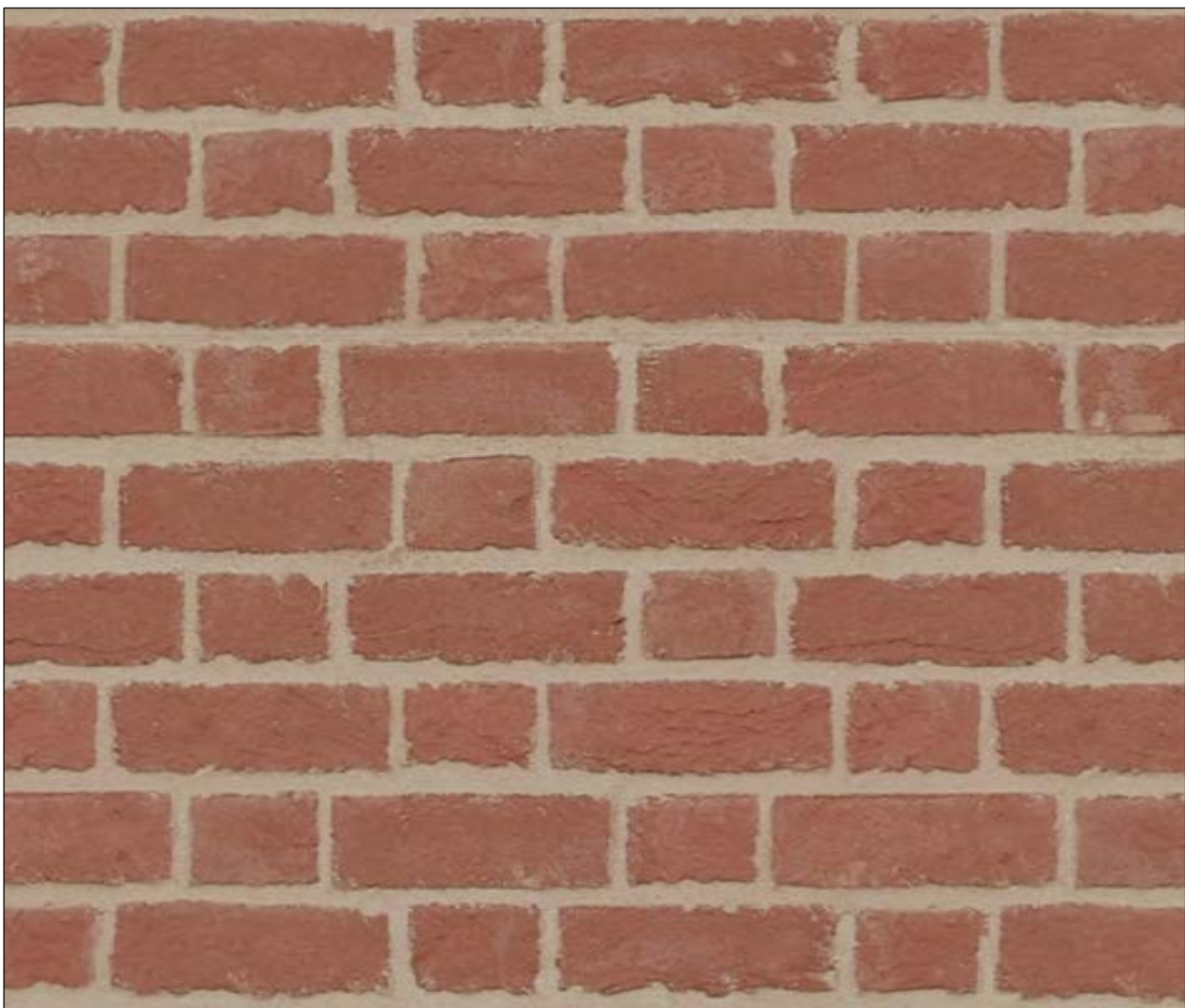

BR-1

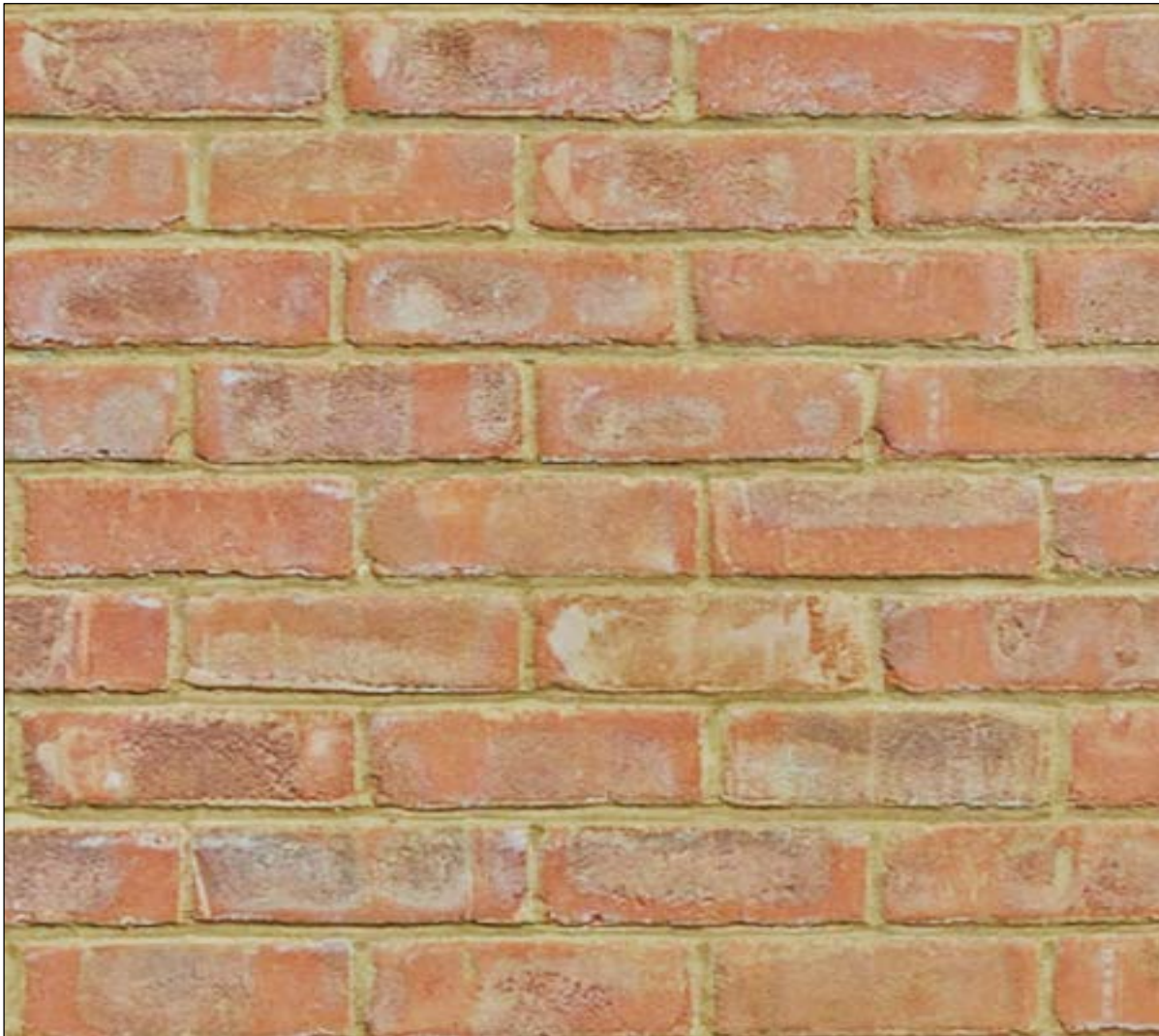

BR-2



ENLARGED ELEVATION



MP-1



BR 2

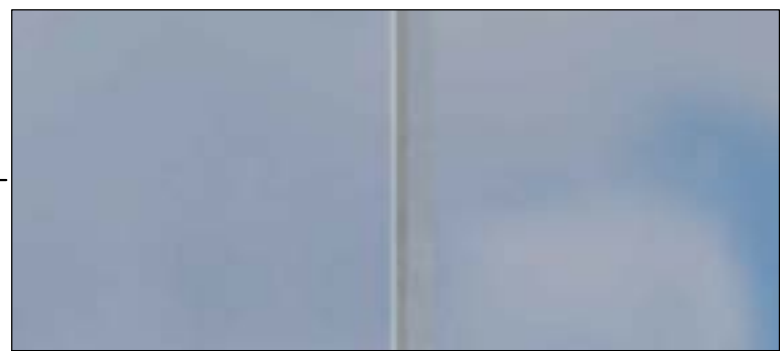

SUNGARD NEUTRAL 61 ON CLEAR



FAIR FACED CONCRETE



BR-1

THE FINAL SELECTION OF THE EXTERIOR COLOR AND MATERIALS WILL VARY WITHIN THE COLOR RANGES AND GENERAL MATERIAL TYPE APPROVED, BASED ON AVAILABILITY AT THE TIME OF CONSTRUCTION.

RICH MARKUS
ARCHITECTS
2601 P STREET NW, 2ND FLR
WASHINGTON DC 20007
202.333.2877 V

SOUTH CAPITOL
STREET SW,
WASHINGTON D.C.

BUILDING MATERIALS
& DETAIL VIEWS

						REVISIONS
--	--	--	--	--	--	-----------



N.T.S

09.02.2022

A401
ZONING COMMISSION
DRAWING NUMBER



SOUTH CAPITOL STREET AND N STREET VIEW

RICH MARKUS
ARCHITECTS

2601 P STREET NW, 2ND FLR
WASHINGTON DC 20007
202.333.2877 V

**SOUTH CAPITOL
STREET SW,
WASHINGTON D.C.**

PROPOSED VIEW

REVIEWS

AS SHOWN

09.02.2022

A500

DRAWING NUMBER



SOUTH CAPITOL ST. SW VIEW

RICH MARKUS
ARCHITECTS
2601 P STREET NW, 2ND FLR
WASHINGTON DC 20007
202.333.2877 V

SOUTH CAPITOL
STREET SW,
WASHINGTON D.C.

PROPOSED VIEW

REVISIONS

AS SHOWN

09.02.2022

A501

DRAWING NUMBER



CORNER OUTDOOR SPACE

RICH MARKUS
ARCHITECTS
2601 P STREET NW, 2ND FLR
WASHINGTON DC 20007
202.333.2877 V

SOUTH CAPITOL
STREET SW,
WASHINGTON D.C.

PROPOSED DETAIL
VIEWS

REVISIONS

AS SHOWN

09.02.2022

A503

DRAWING NUMBER



N STREET OUTDOOR SPACE

RICH MARKUS
ARCHITECTS
2601 P STREET NW, 2ND FLR
WASHINGTON DC 20007
202.333.2877 V

SOUTH CAPITOL
STREET SW,
WASHINGTON D.C.

PROPOSED DETAIL
VIEWS

REVISIONS

AS SHOWN

09.02.2022

A504

DRAWING NUMBER



N STREET OUTDOOR SPACE

RICH MARKUS
ARCHITECTS
2601 P STREET NW, 2ND FLR
WASHINGTON DC 20007
202.333.2877 V

SOUTH CAPITOL
STREET SW,
WASHINGTON D.C.

PROPOSED DETAIL
VIEWS

REVISIONS

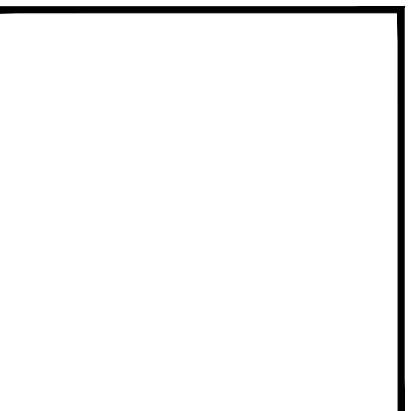

AS SHOWN

09.02.2022

A505
DRAWING NUMBER



SOUTH CAPITOL ST VIEW

RICH MARKUS
ARCHITECTS
2601 P STREET NW, 2ND FLR
WASHINGTON DC 20007
202.333.2877 V

SOUTH CAPITOL
STREET SW,
WASHINGTON D.C.

PROPOSED VIEW

REVISIONS



AS SHOWN

09.02.2022

A506
DRAWING NUMBER



N- STREET NIGHT VIEW

RICH MARKUS
ARCHITECTS

2601 P STREET NW, 2ND FLR
WASHINGTON DC 20007
202.333.2877 V

SOUTH CAPITOL
STREET SW,
WASHINGTON D.C.

PROPOSED VIEW

REVISIONS

AS SHOWN

07.18.2022

A508

DRAWING NUMBER



RICH MARKUS
ARCHITECTS

2601 P STREET NW, 2ND FLR
WASHINGTON DC 20007
202.333.2877 V

**SOUTH CAPITOL
STREET SW,
WASHINGTON D.C.**

PROPOSED VIEW

REVISIONS						
-----------	--	--	--	--	--	--

AS SHOWN

07.18.2022

A509

DRAWING NUMBER

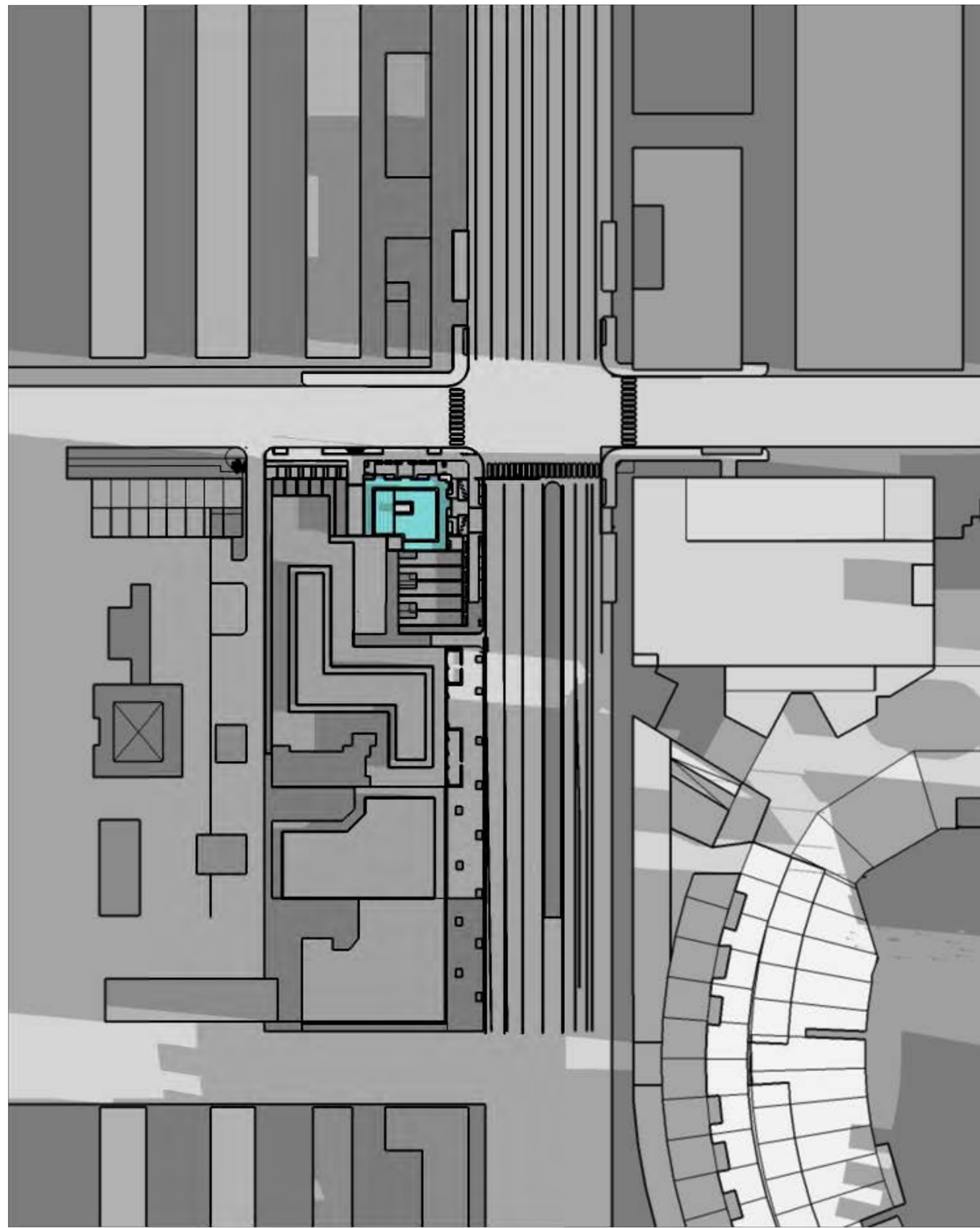

1 March/September @9:00AM
NTS

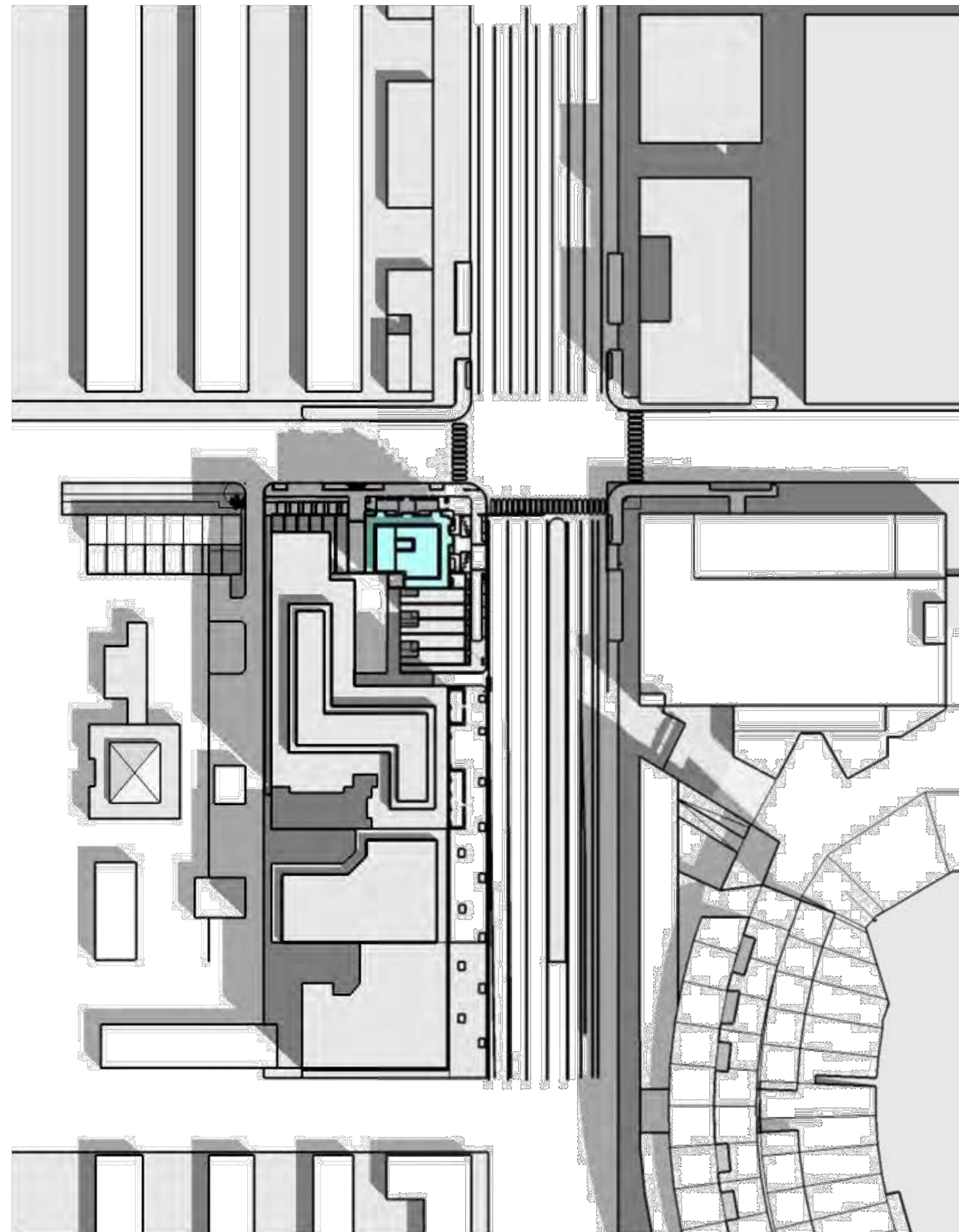

2 March/September @12:00PM
NTS

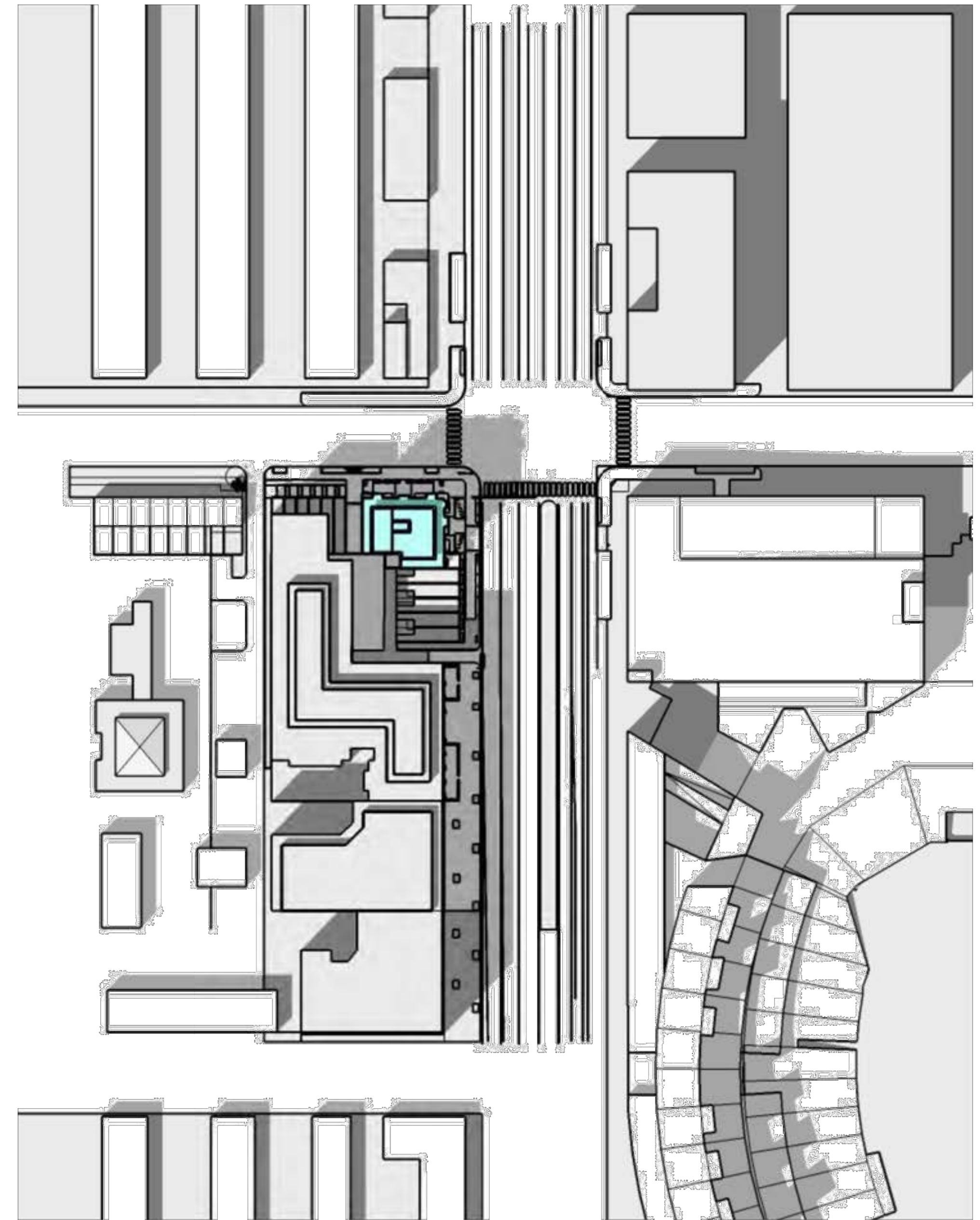

3 March/September @4:00PM
NTS

RICH MARKUS
ARCHITECTS
2601 P STREET NW, 2ND FLR
WASHINGTON DC 20007
202.333.2877 V

SOUTH CAPITOL
STREET SW,
WASHINGTON D.C.

SHADOW STUDY

REVISIONS				

AS SHOWN

07.18.2022

A510

DRAWING NUMBER

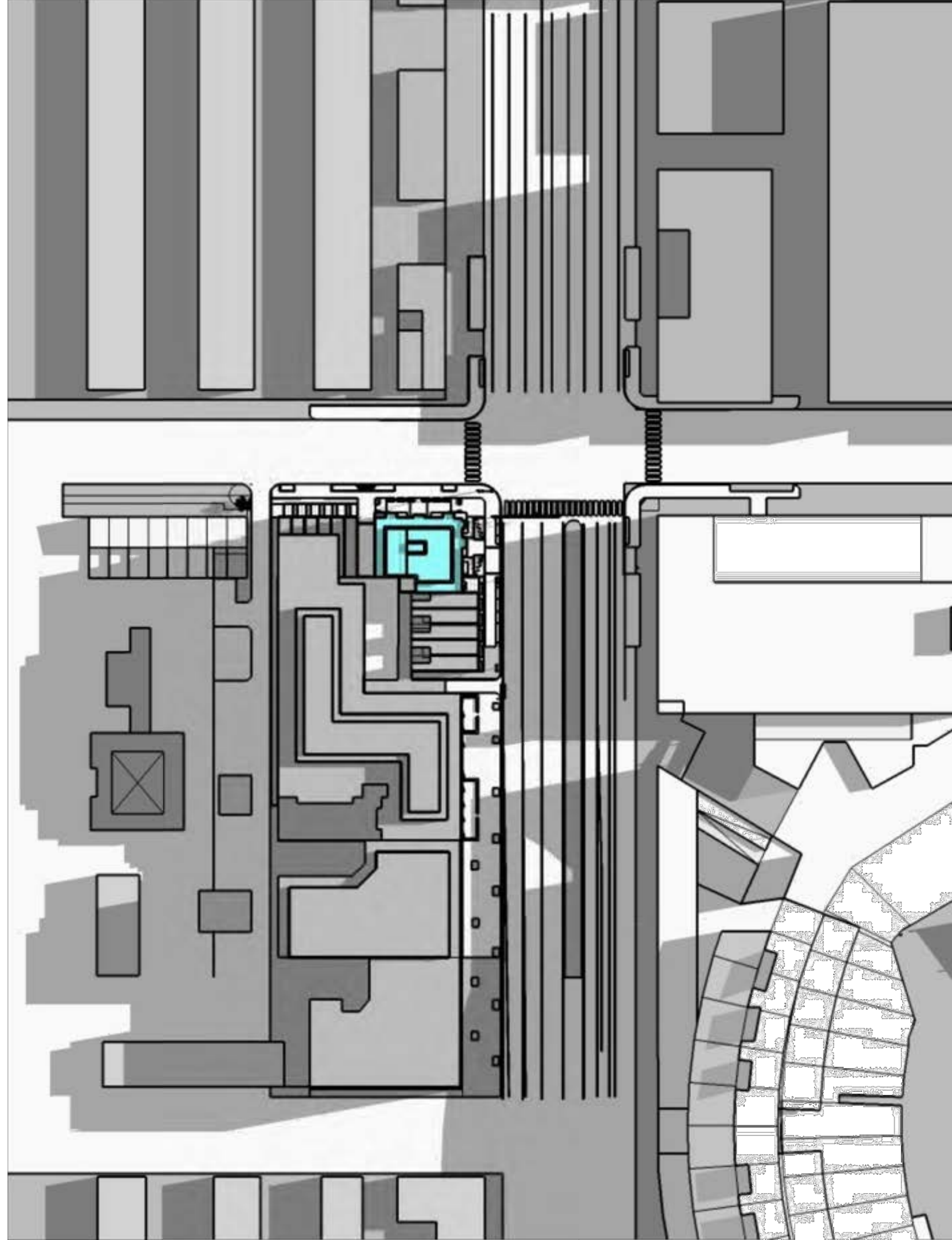

1 JULY 01 @9:00AM
NTS

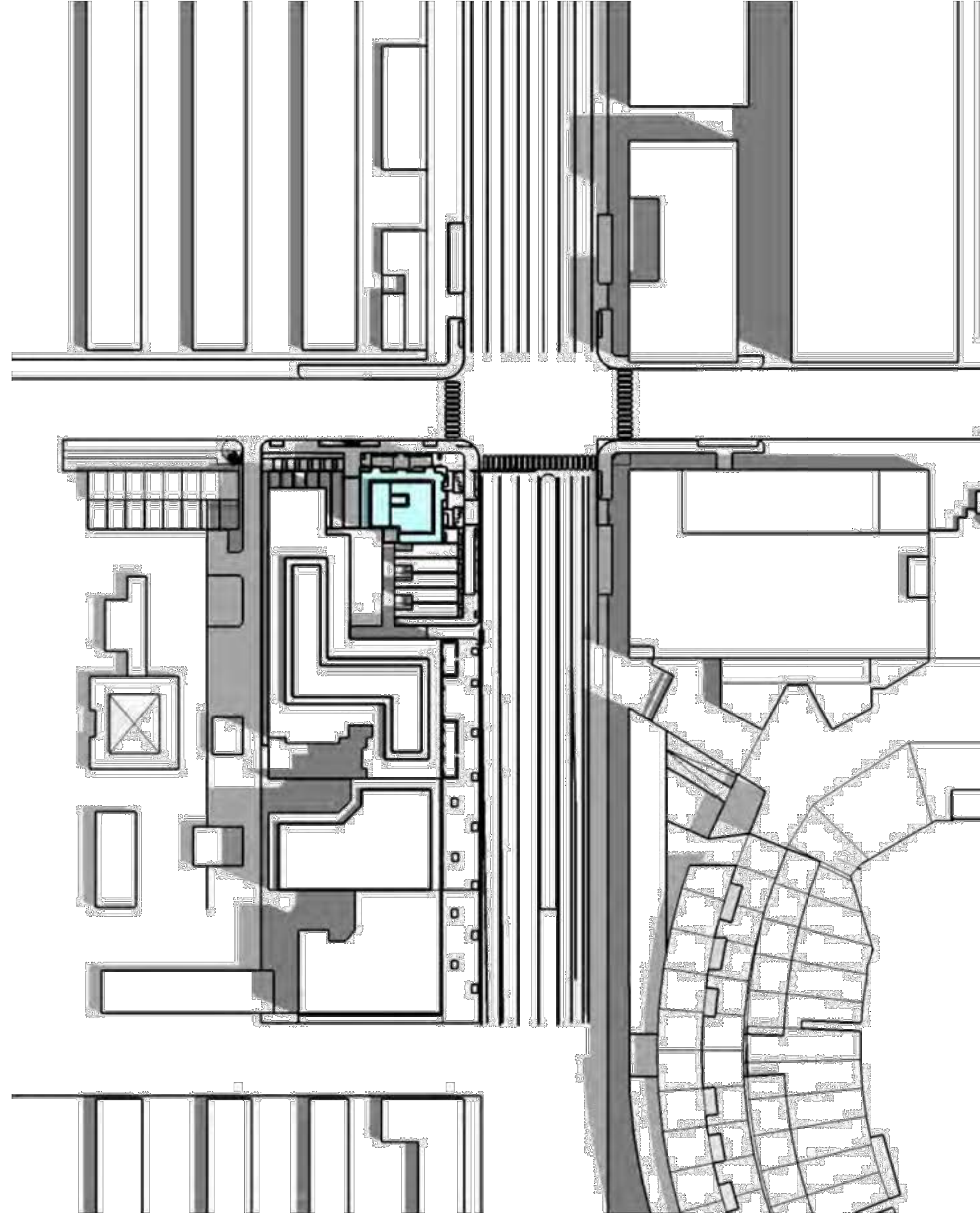

2 JULY 01 @12:00PM
NTS

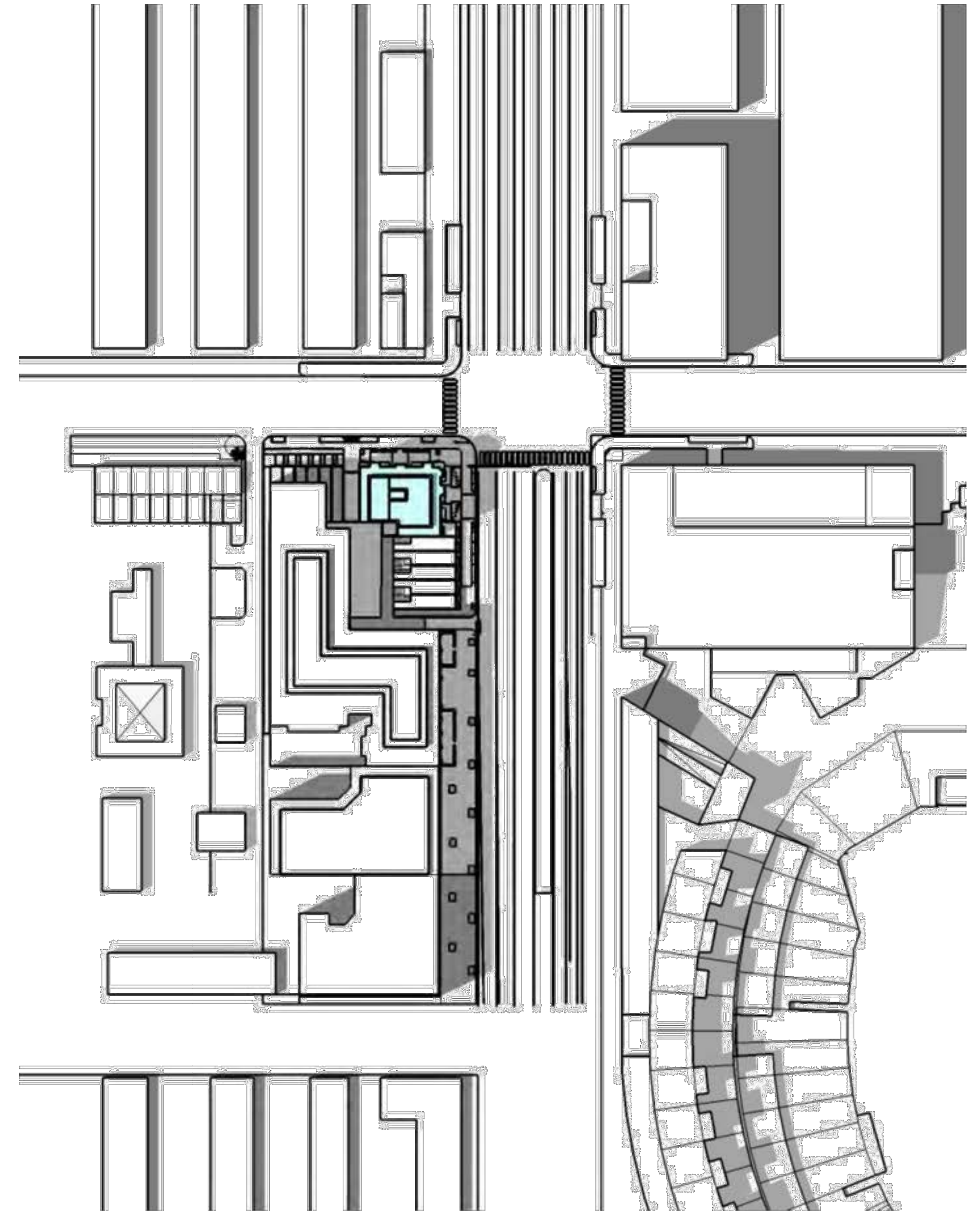

3 JULY 01 @4:00PM
NTS

RICH MARKUS
ARCHITECTS
2601 P STREET NW, 2ND FLR
WASHINGTON DC 20007
202.333.2877 V

SOUTH CAPITOL
STREET SW,
WASHINGTON D.C.

SHADOW STUDY

REVISIONS

AS SHOWN

07.18.2022

A511

DRAWING NUMBER

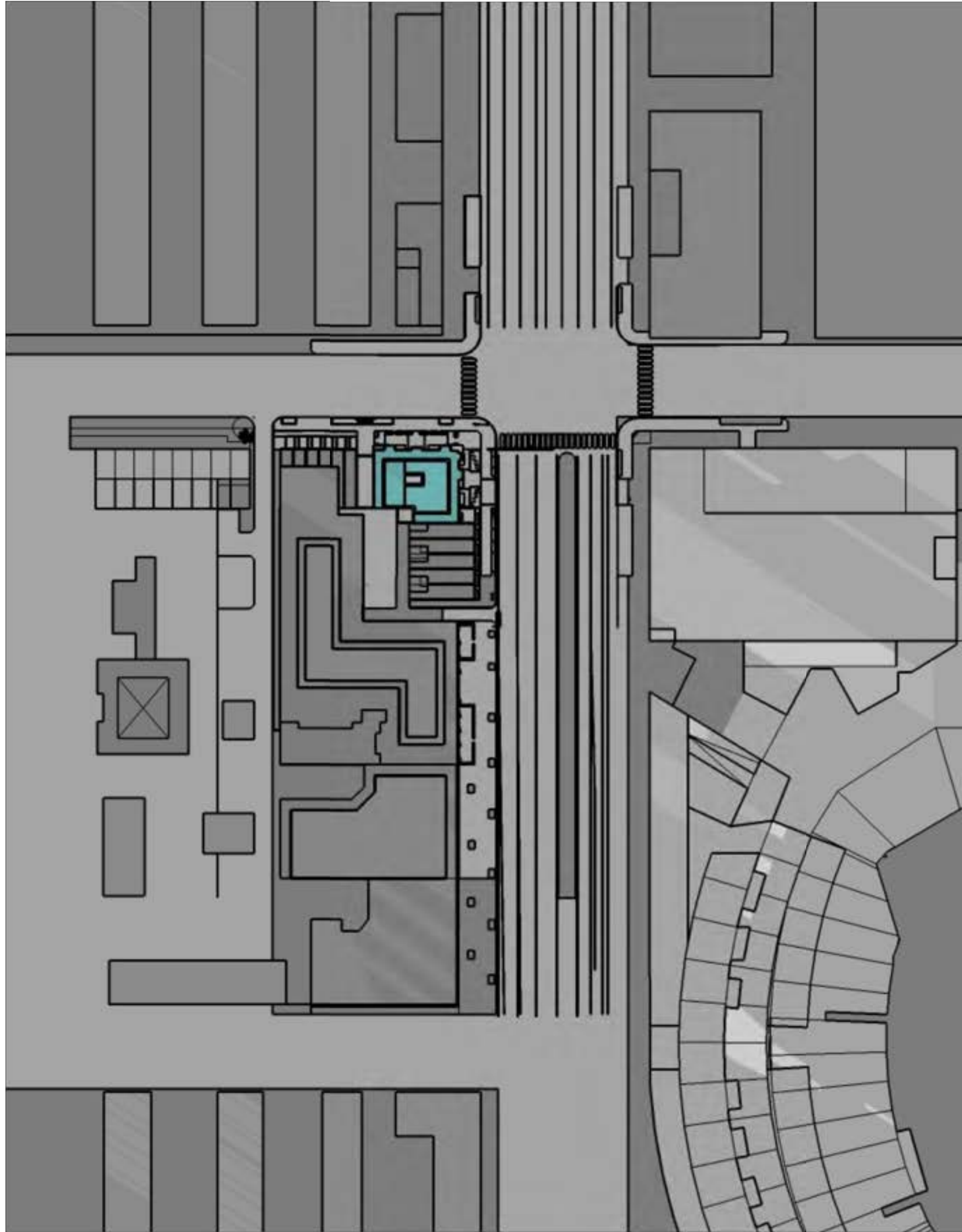

1 DECEMBER 01 @9:00AM
NTS

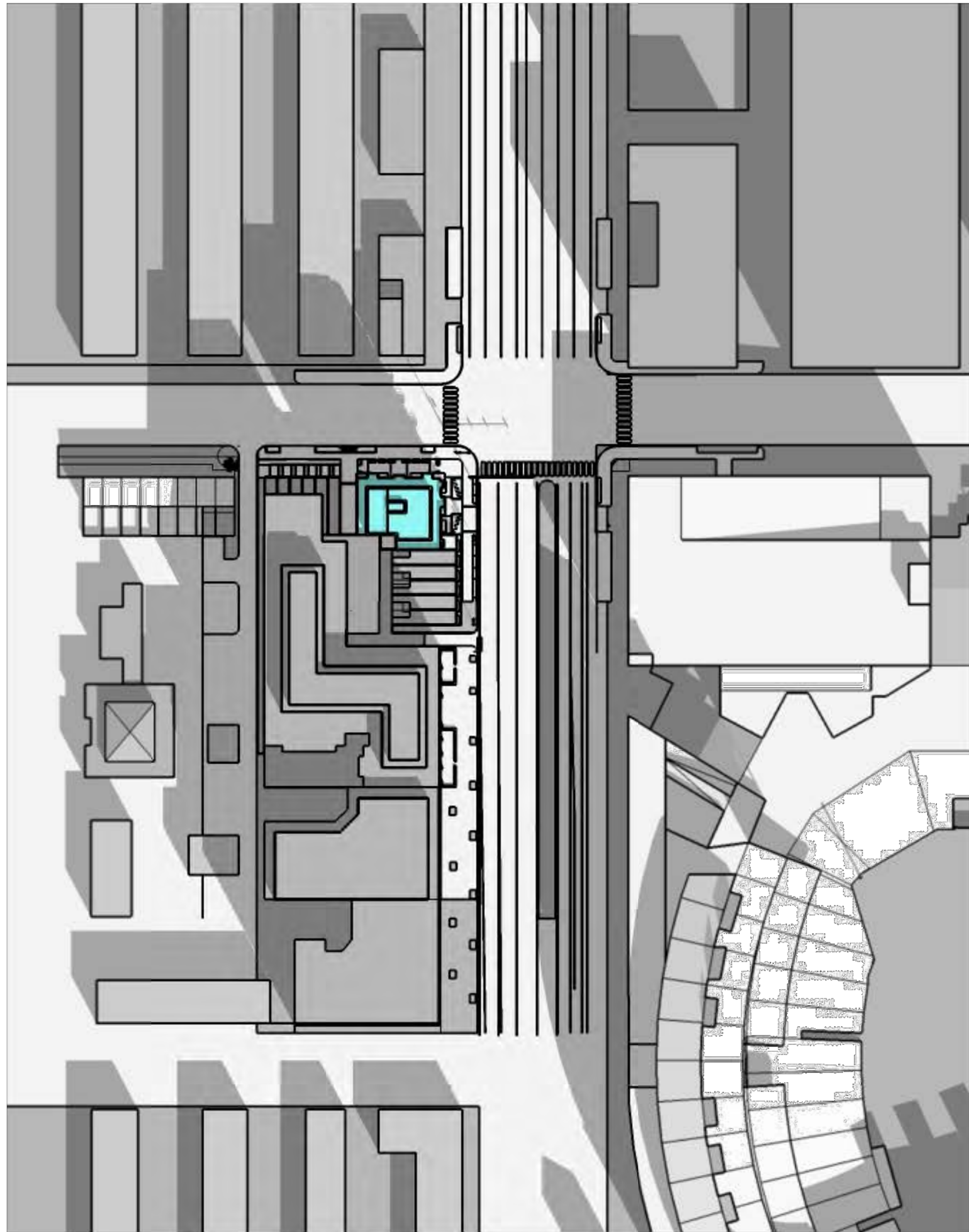

2 DECEMBER 01 @12:00PM
NTS

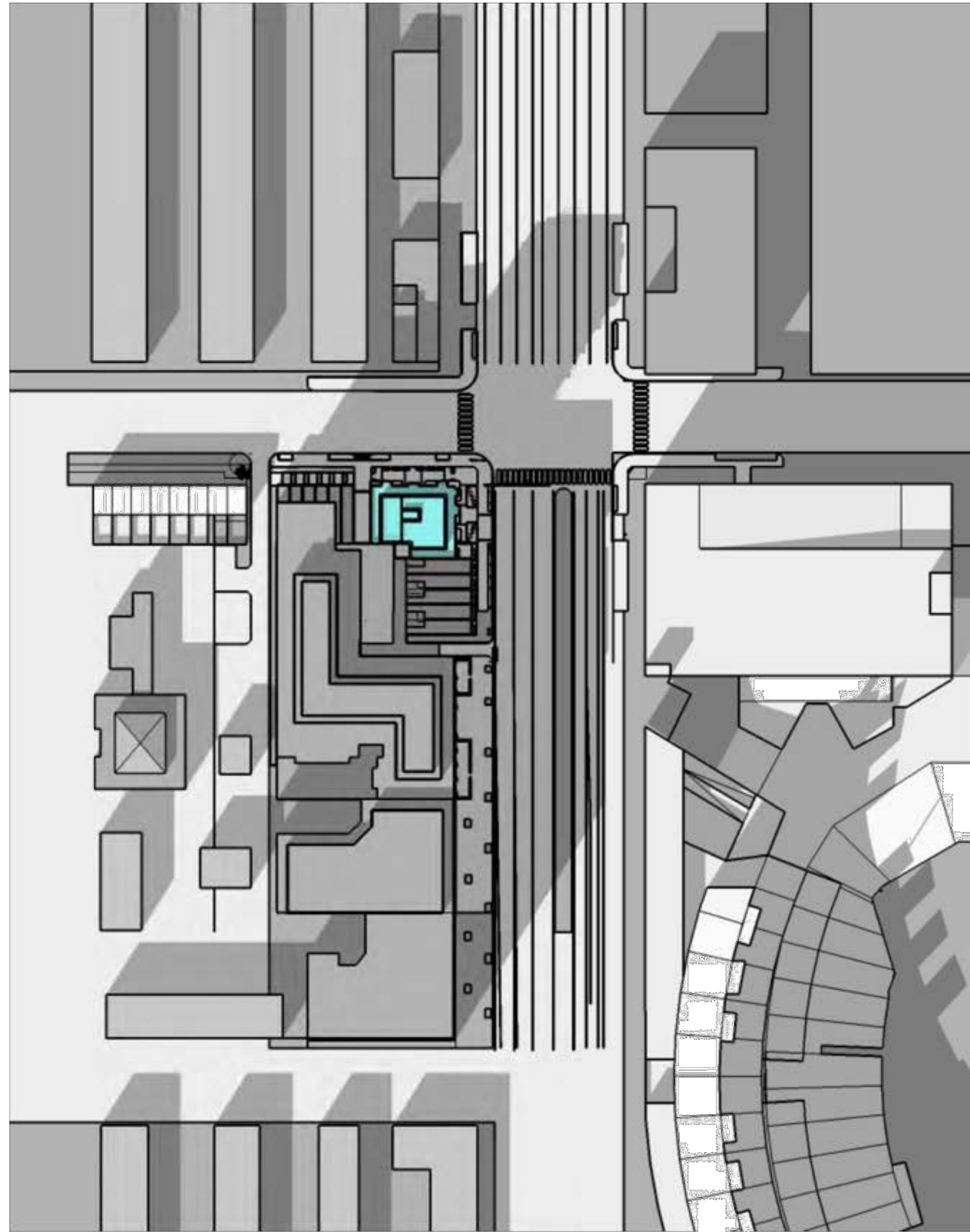

3 DECEMBER 01 @4:00PM
NTS

RICH MARKUS
ARCHITECTS
2601 P STREET NW, 2ND FLR
WASHINGTON DC 20007
202.333.2877 V

SOUTH CAPITOL
STREET SW,
WASHINGTON D.C.

SHADOW STUDY

REVISIONS				



AS SHOWN

07.18.2022

A512
DRAWING NUMBER